

Installation Speaker

WS-15T/30T/50T/80T



▶ WS-15T ▶ WS-30T ▶ WS-50T ▶ WS-80T

FEATURES

- High-quality Trans for Low/High
- Water and damp-proof of IP54
- Designed to Minimize Sound Distortion
- Consolidated Transmission of Low-pitched Sound
- Aesthetic Design
- Ease of Installation
- EASE, EASE Focus Data

SPECIFICATIONS

	WS-15T	WS-30T	WS-50T	WS-80T
TYPE	1 way full range	2 way passive	2 way passive	2 way passive
FREQUENCY RANGE (-10dB)	110Hz-20kHz	100Hz-20kHz	100Hz-20kHz	100Hz-20kHz
SENSITIVITY(1m/1W)	84dB	85dB	87dB	90dB
COMPONENT	LF	4"	5"	6.5"
	HF			
POWER HANDLING	15W(RMS)	30W(RMS)	50W(RMS)	80W(RMS)
NOMINAL IMPEDANCE	LOW	8Ω	8Ω	8Ω
	HI 100V	15W_666Ω	30W/15W_333Ω/666Ω	50W/25W_200Ω/400Ω
CONNECTORS	Screw terminal 2P			
ENCLOSURE MATERIAL	ABS RESIN			
WEIGHT	0.89kg/1.96lb	1.7kg/3.75lb	2.31kg/5.09lb	3.55kg/7.83lb
DIMENSIONS(W x H x D)	92x120x114(mm) / 3.6x4.7x4.5(in)	139x210x129(mm) / 5.5x8.3x5.1(in)	173x250x150(mm) / 6.8x9.8x5.9(in)	210x311x169(mm) / 8.3x12.2x6.7(in)

* Design and specification are subject to be changed for the improvement of product quality without pre notice.

* When using high impedance, do not convert to 8Ω . It may cause an outbreak of fire due to overvoltage pressure.

PERFORMANCE CURVE

▶ WS-15T

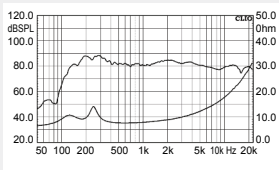

▶ WS-30T

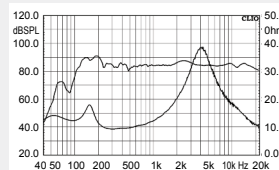

▶ WS-50T

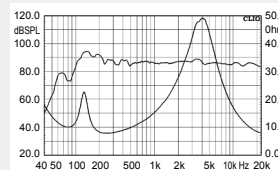

▶ WS-80T

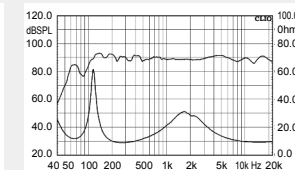

DIMENSIONAL

▶ WS-15T

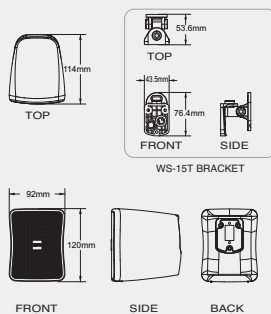

▶ WS-30T

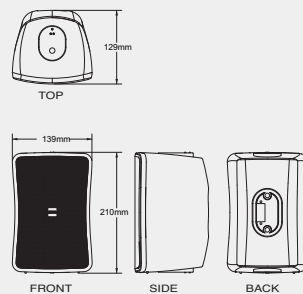

▶ WS-50T

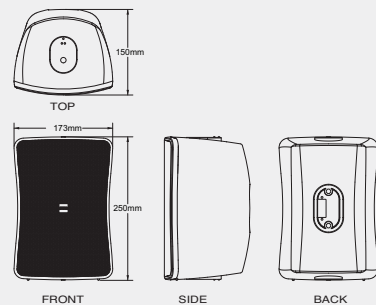

WS-15T/30T/50T/80T



DIMENSIONAL

▶ WS-80T

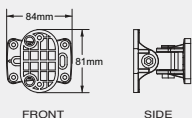
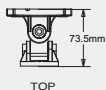
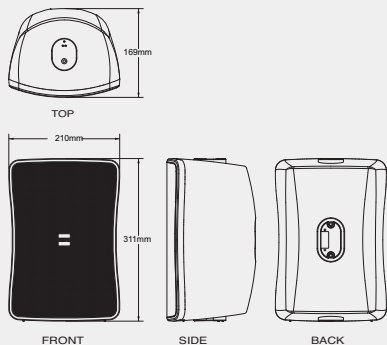

KNUCKLE BRACKET
(WS-30T/WS-50T/WS-80T)

▶ WS-30T

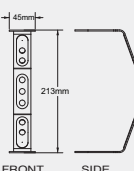

▶ WS-50T

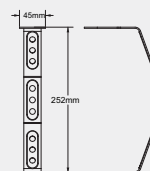

U-BRACKET

▶ WS-80T

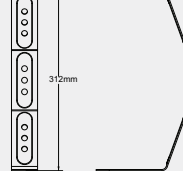

U-BRACKET INSTALLATION

▶ WS-30T/WS-50T/WS-80T

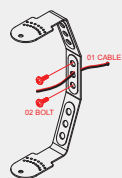

STEP 01

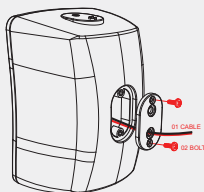

STEP 02

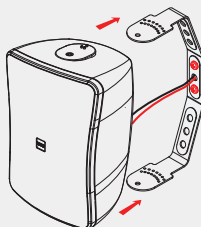

STEP 03

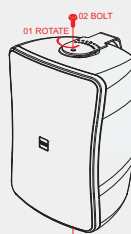

STEP 04



STEP 05

KNUCKLE BRACKET INSTALLATION

▶ WS-15T



STEP 01

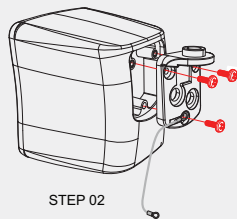

STEP 02

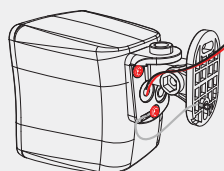

STEP 03

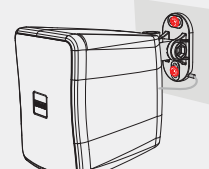

STEP 04

▶ WS-30T/WS-50T/WS-80T



STEP 01

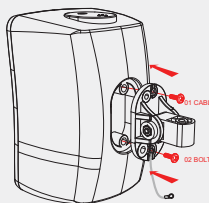

STEP 02

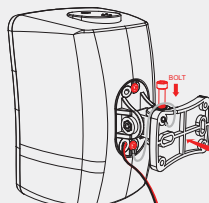

STEP 03

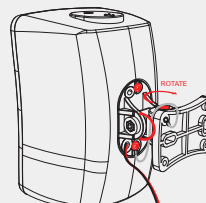

STEP 04

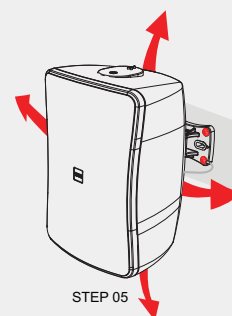

STEP 05

* When you install outdoor, Please install by inserting the waterproof back-gasket.

Inter-M Corporation

- Office : 719, DOBONG-RO, DOBONG-GU, SEOUL, KOREA
 - Tel : +82-2-2289-8140~8, Fax : +82-2-2289-8149
 - Home page: <http://www.inter-m.com>, E-mail: overseas@inter-m.com

Inter-M Corp. (IMA)

- Office : 5666 CORPORATE AVE. CYPRESS, CA 90630
 - Tel : +1-714-828-2200, Fax : +1-714-828-2210
 - E-mail : info@inter-m.net, Home Page : www.inter-m.net

